

## BioSci Zoom Room Quick Start Guide

### To present in room (wired)

1. Turn on the displays using the power button on the wall.
2. You will see a BioSci logo.
3. Plug the HDMI cable from the wall plate into your laptop. Content will automatically show up on all displays in the room.

### To present in room (wireless)

1. Turn on the displays using the power button on the wall.
2. You will see a BioSci logo.
3. Open the Zoom app on your laptop/device and click the share screen button.

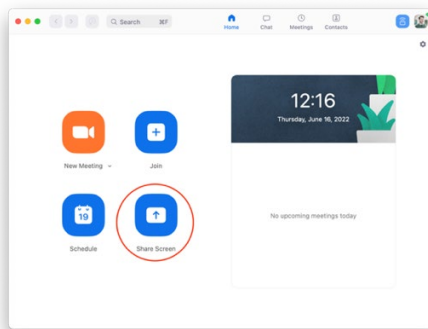

4. If your screen doesn't automatically share, you will be prompted to enter the **"Sharing Key"** from the top right-corner of the TV. This will wirelessly share your

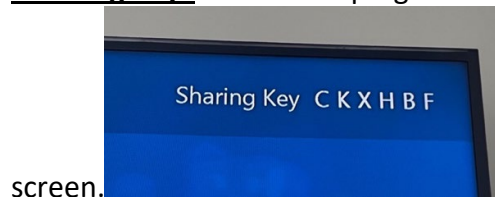

screen.

### To Zoom

1. Turn on the displays using the power button on the wall.
2. You will see a BioSci logo.
3. Use the TAP touchscreen display next to the TV to start and control your meeting. You may share to the Zoom using one of the two above methods.

### To Connect to WiFi

1. Connect to UCI-Guest from your device and follow the prompts to agree to the terms.

### For each pod to show its own video

1. Press the Video button on the wall panel. This will switch the pod displays' input.
2. Users can plug in to HDMI under the table of each pod.
3. To revert back, press the Video button on the wall panel again.